

Matthews Station

110 Matthews Station Street • Matthews, NC 28105

SPACE FOR LEASE

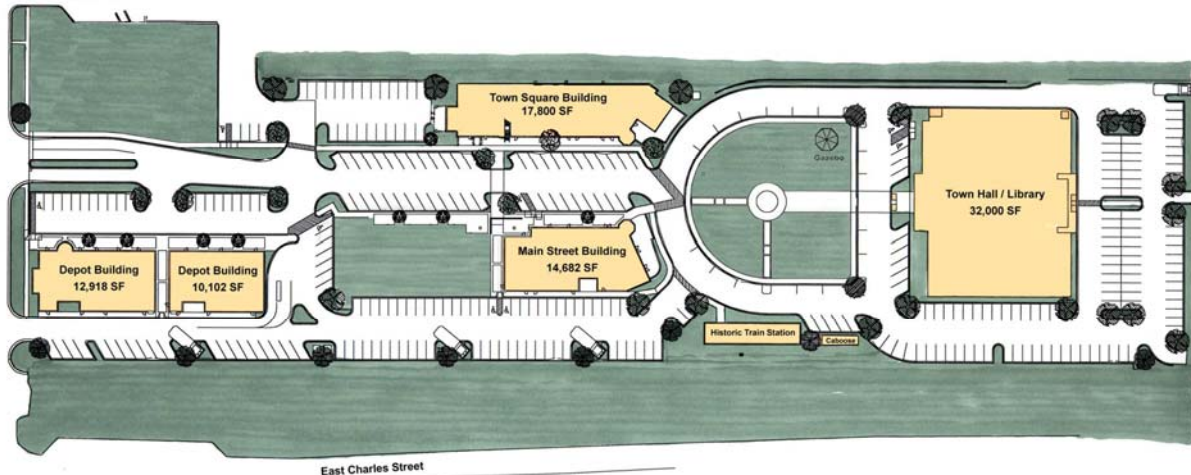

Features:

- Matthews Station offers more than 50,000 square feet of restaurant, retail, office and medical spaces
- Adjacent to new 32,000 square foot Mecklenburg County Public Library and Matthews Town Hall
- Close proximity to Highway 51 and I-485 as well as Presbyterian Hospital
- 31,000 cars per day on Trade Street
- Connectivity with Matthews-Mint Hill Road
- Other tenants include: Wingate University, Subway, Beantown Tavern, Thai Taste, Dilworth Coffee, RBC Centura

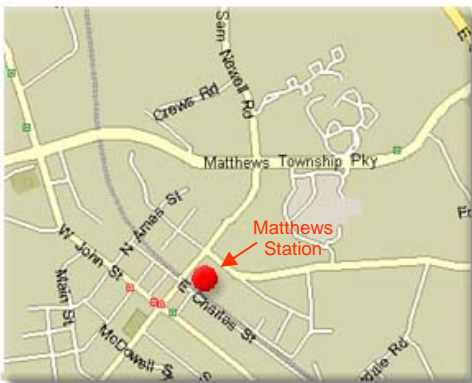

2010 Demographics

	One Mile	Three Miles	Five Miles
Population	5,243	60,720	150,613
Daytime Population	8,717	29,530	51,979
Avg. HH Income	\$77,397	\$97,780	\$97,762
Median HH Income	\$66,973	\$78,499	\$77,570



for information:

JD Yearwood
 telephone: 704.519.4232
 jd.yearwood@latpurser.com

4530 Park Road, Suite 300, Charlotte, NC 28209
 telephone: 704.519.4200 • fax: 704.525.8700 • www.latpurser.com

No warranty or representation, expressed or implied, is made to the accuracy of the information contained herein.

Matthews Station

Depot Building

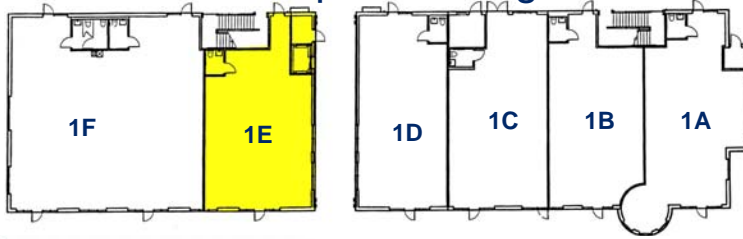

Suite	Tenants	SF
250-1F	RBC Centura Bank	3,300
250-1E	AVAILABLE	1,554
250-1D	Jamison Realty	1,585
250-1C	Preslar Dry Cleaner	1,700
250-1B	Foot Solutions	1,485
250-1A	Dilworth Coffee House	1,683

Town Square Building

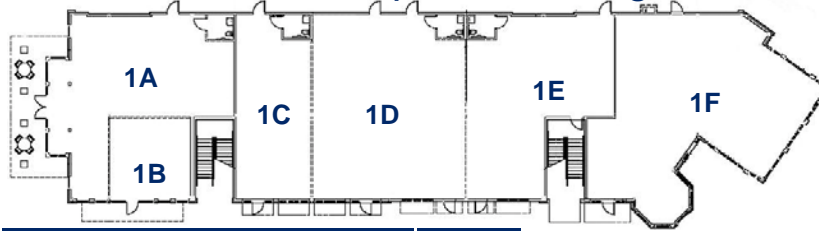

Suite	Tenants	SF
249-1A	Subway	1,600
249-1B	Matthews Station Wine Merchant	500
249-1C	E.G. Couture Bridal Accessory & Consignment	1,480
249-1D	Attitudes Salon	1,513
249-1E	Jimmie's Sweets	1,529
249-1F	Thai Taste	2,250



Main Street Building

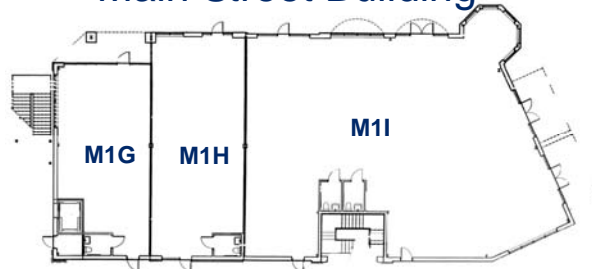

Suite	Tenants	SF
M1G	Nail 3	1,215
M1H	Chiropractic Health of Matthews	1,500
M1I	Beantown Tavern	4,500