

10801 Monroe Road

Matthews, North Carolina 28105



Features:

- 773 RSF - 3,325 RSF Available
- Elevator Access
- Monument Street Signage
- Excellent Visibility from Monroe Road
- Located 1 Mile From The Galleria Shops and Residential Living Community

***See Floor Plans On Back**

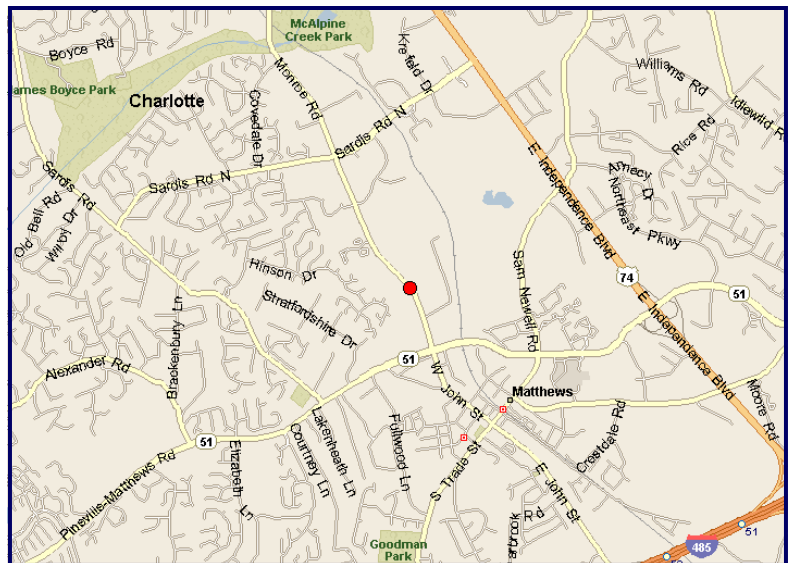

LPA

Lat Purser
& Associates, Inc.

for information:
Chad Hagerman
telephone: 704.519.4254
chad.hagerman@latpurser.com

4530 Park Road, Suite 300, Charlotte, NC 28209
telephone: 704.519.4200 • fax: 704.525.8700 • www.latpurser.com

No warranty or representation, expressed or implied, is made to the accuracy of the information contained herein.

10801 Monroe Road

Matthews, North Carolina 28105

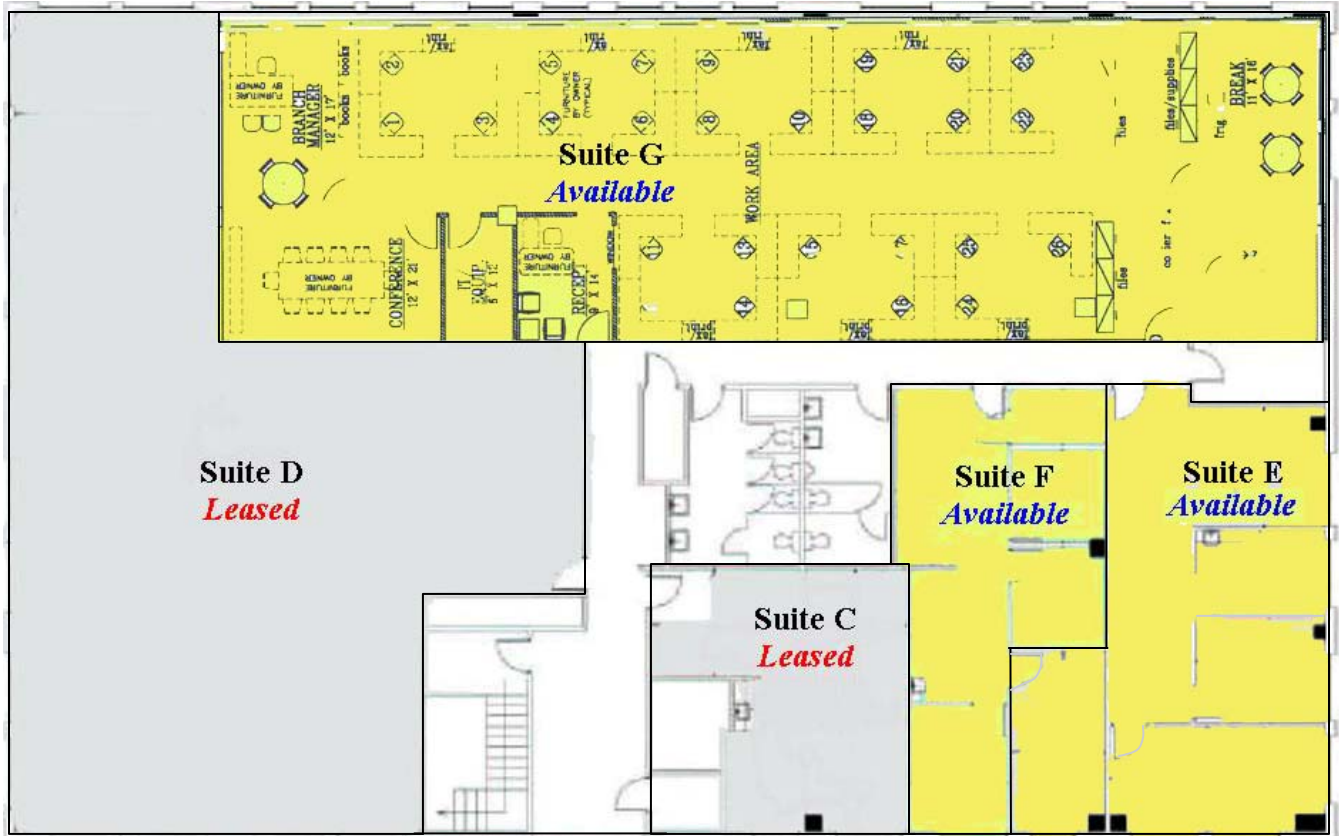

- Suite E 1177 RSF
- Suite F 773 RSF
- Suite G 3325 RSF



LPA

Lat Purser
& Associates, Inc.

for information:

Chad Hagerman

telephone: 704.519.4254

chad.hagerman@latpurser.com

4530 Park Road, Suite 300, Charlotte, NC 28209
telephone: 704.519.4200 • fax: 704.525.8700 • www.latpurser.com

No warranty or representation, expressed or implied, is made to the accuracy of the information contained herein.